

7	LED		
6	Liner	Tin Plate	
5	Movable Contact	Stainless Steel	Ag Plated 0.5 μ m
4	Fixed Contact	Brass C2680	Ag Plated 0.5 μ m
3	Frame	Copper Alloy C7701	
2	Knob	HTN-BK	
1	Case	HTN-BK	
No.	Parts	Material	Finish

LED Specifications														
Power Dissipation Pd (mW)	Peak Pulsing Current Ifp (mA)	Forward Current If (mA)	Electrostatic Discharge ESD (V)	Operating Temperature Range (°C)	Storage Temperature Range (°C)	Lead Soldering Temperature T sol								
75	100	30mA	2000	-40~+85	-40~+85	260°C for 5S								
Test Condition	Viewing Angle at 50% Iv $2\theta_{1/2}$	Wave Length λ_p (nm)			Spectral Half Bandwidth $\Delta\lambda$ (nm)			Luminous Iv (mcd)			Forward Voltage Vf (V)			
		Min.	Typ.	Max.	Min.	Typ.	Max.	Min.	Typ.	Max.	Min.	Typ.	Max.	
White Orange	IF=20mA	120	X=0.310 Y=0.310(CIE)			—			320	450	600	2.8	3.1	3.7
			585	590	595	15	250	300	500	1.9	2.0	2.3		

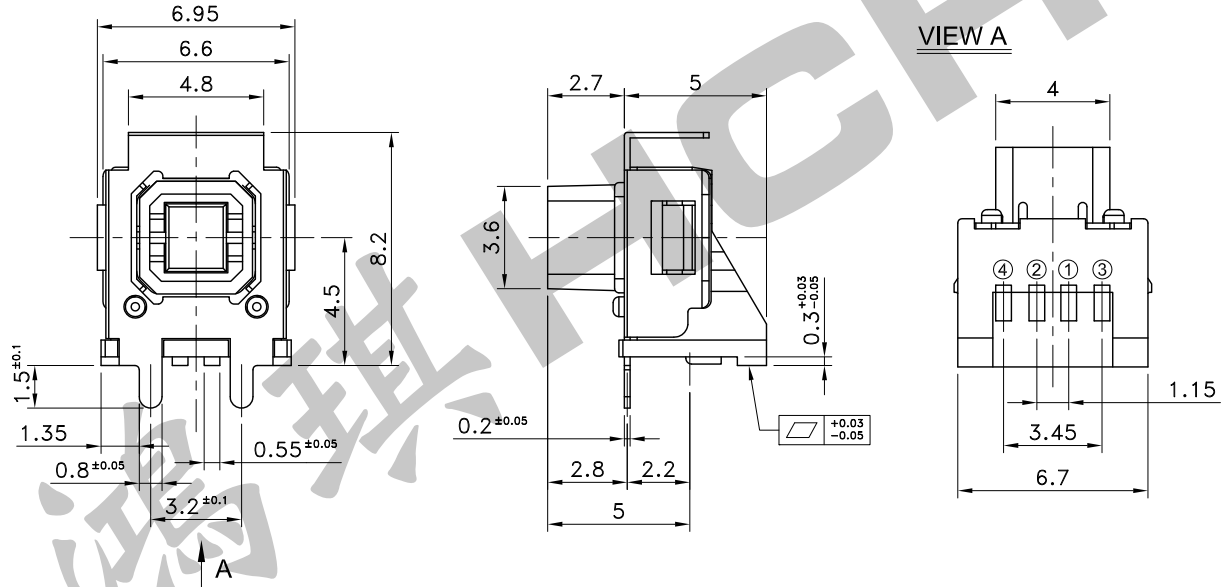

P.C.B TERMINAL POSITION

CIRCUIT ARRANGEMENT

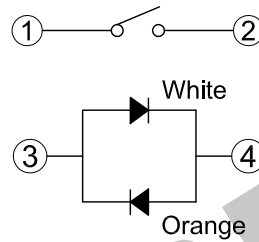
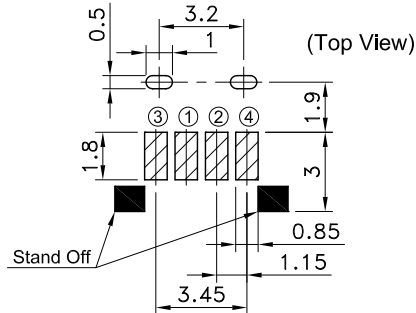

SOLDERING CONDITIONS

SPECIFICATIONS

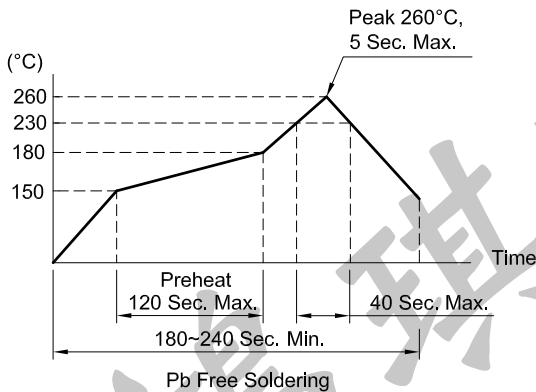

1. Rating : DC 12V 50mA
2. Contact Resistance : 100m Ω Max.
3. Insulation Resistance : 100M Ω Min. at DC 100V
4. Dielectric Strength : AC 250V for 1 Minute
5. Operating Force : 220 \pm 50gf
6. Stroke : 0.25 \pm 0.1mm
7. Life : 100,000 Cycles
8. Package : 400 Pcs/Reel
9. Operating Temperature Range : -25~+85°C
10. Storage Temperature Range : -30~+80°C
11. Manual soldering : Tip Temperature 350°C Max.
Soldering Time 3 Sec. Max.

REVISION: _____ DATE: _____ REVISION: _____ DATE: _____

UNIT:mm THIRD ANGLE PROJECTION METHOD TOL. UNLESS OTHERWISE STATED:±0.3 CODE NO.: HCH-2540

ISSUED	CONFIRMED		HORNG CHIH 鴻琪股份有限公司	PART NO.
<i>John</i> 2023.11.03	<i>Elvis</i> 2023.11.03			PTS-313-L69