

6	Button	POM		94HB, Nature
5	Movable Contact	Phosphor Bronze	Silver Plating 1μm	
4	Spring	Piano Wire	Oil Treated	
3	Terminal	Phosphor Bronze	Silver Plating 1μm	
2	Cover	PA66		94HB, Black
1	Case	PBT		94V-0, Black
No.	Parts	Material	Finish	Remarks

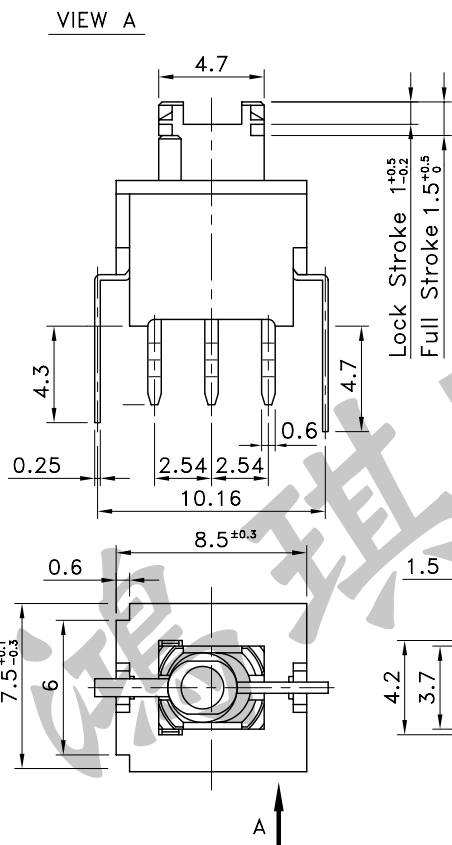

LED Specifications						
Symbol	Color	V _R	I _F	Recommended Operating Current	V _F	
					Nom	Max.
L2	Red	DC 5V	30mA	20mA	2.0V	2.8V
L5	Green	DC 5V	20mA	15mA	1.95V	2.5V
L8	Yellow	DC 5V	20mA	15mA	1.9V	2.5V

Push To Lock	Push No Lock
PTS-210S-L2	PTS-210N-L2
PTS-210S-L5	PTS-210N-L5
PTS-210S-L8	PTS-210N-L8

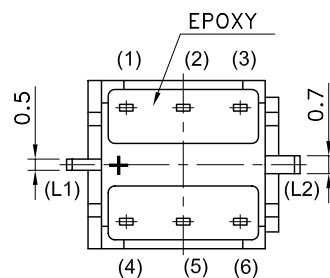

P.C.B TERMINAL POSITION

CIRCUIT ARRANGEMENT

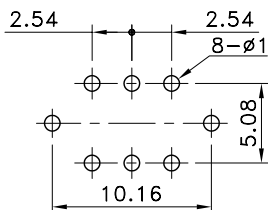

Type	Circuit Characteristics			
	Circuit Arrangement		Circuit Diagram	
	Normally Closed	ON		
PTS-210N-L □	Push No Lock	(1) - (2) (4) - (5)	(2) - (3) (5) - (6)	
PTS-210S-L □	Push To Lock	(1) - (2) (4) - (5)	(2) - (3) (5) - (6)	

SOLDERING CONDITIONS

	Temperature (°C)	Time (Sec.)
Auto Soldering	245 Max.	5±0.5
Manual Soldering	380±10	3±0.5

SPECIFICATIONS

- Rating : DC 30V 100 mA
- Contact Resistance : 50mΩ Max.
- Insulation Resistance : 100MΩ Min. at DC 500V
- Dielectric Strength : AC 500V for 1 Minute
- Operating Force : Push No Lock:150±100gf
Push To Lock:250±100gf
- Stroke : Full Stroke:1.5^{+0.5}₀ mm
Lock Stroke:1^{+0.5}_{-0.2} mm
- Life : 10,000 Cycles
- Operating Temperature Range : -10~+70°C

REVISION:	DATE:	REVISION:	DATE:
UNIT:mm	THIRD ANGLE PROJECTION METHOD	TOL. UNLESS OTHERWISE STATED:±0.3	CODE NO.: HCH-402
ISSUED	CONFIRMED	PART NO.	
John	Joey	PTS-210	
2003.08.07	2003.08.07	HORNG CHIH 鴻琪股份有限公司	