

Part No.	Operating Force
PTS-171-A	160 <sup>+70</sup> <sub>-40</sub> gf
PTS-171-B	220 <sup>+80</sup> <sub>-70</sub> gf

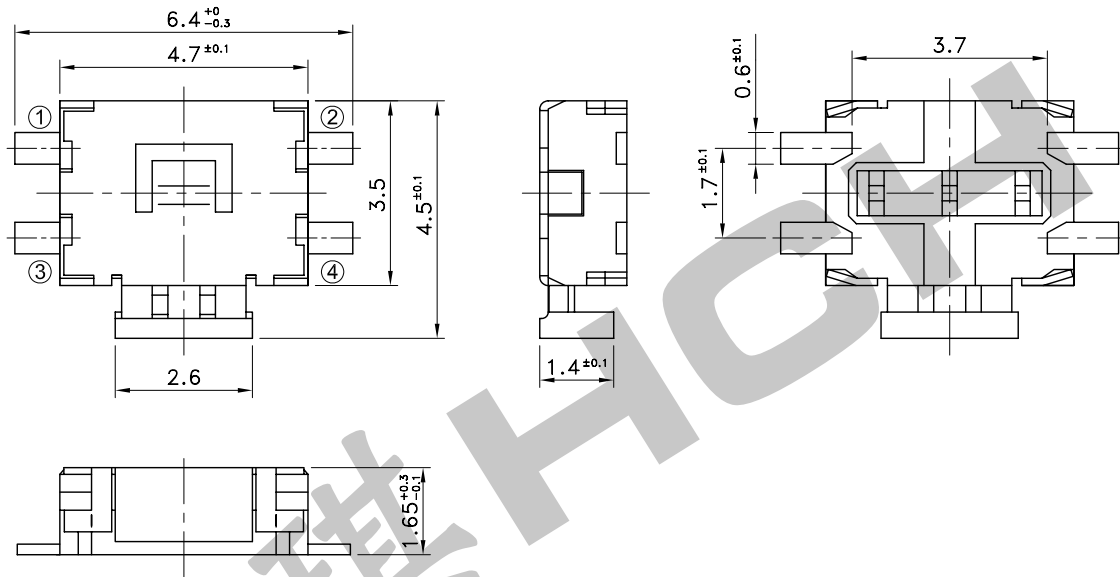

### P.C.B TERMINAL POSITION

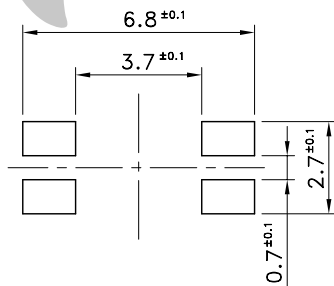

### CIRCUIT ARRANGEMENT

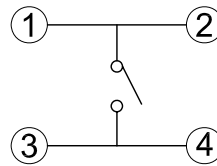

### SOLDERING CONDITIONS

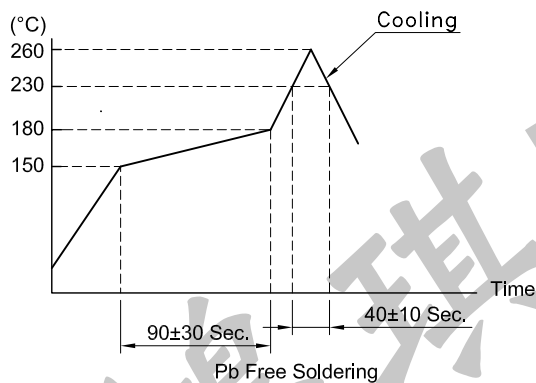

### SPECIFICATIONS

1. Rating : DC 12V 50mA Max.
2. Contact Resistance : 500mΩ Max.
3. Insulation Resistance : 100MΩ Min. at DC 100V
4. Dielectric Strength : AC 250V for 1 Minute
5. Stroke : 0.3<sup>+0.1</sup><sub>-0.2</sub> mm
6. Life : 100,000 Cycles
7. Taping : 4,000 Pcs/Reel
8. Operating Temperature Range : -20~+70°C
9. Storage Temperature Range : -40~+85°C (Bulk)  
: -20~+60°C (Taping)
10. Reflow Soldering Profile : According Reflow Profile  
2 Times
11. Manual soldering : Tip Temperature 280°C Max.  
Soldering Time 3 Sec. Max.

REVISION:		DATE:		REVISION:		DATE:	
UNIT:mm		THIRD ANGLE PROJECTION METHOD		TOL. UNLESS OTHERWISE STATED:±0.2		CODE NO.:HCH-1664	
ISSUED		CONFIRMED		<b>HCH</b> ISO9001 Certified ISO14001 Certified <b>HORNG CHIH</b> 鴻琪股份有限公司		PART NO.	
<i>John</i>		<i>Elvis</i>				<b>PTS-171</b>	
2010.05.25		2010.05.25					