

FPC • FFC CONNECTOR
 PITCH:0.5mm H:3.4mm
 AUTO I-LOCK™
FPC26 SERIES

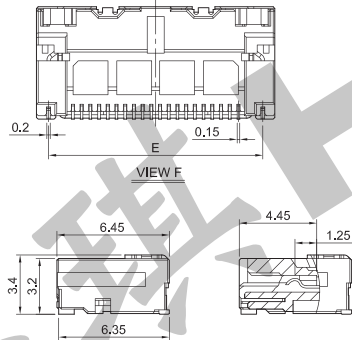

- Rating: AC/DC50V 0.5A
- Insulation Resistance: 50Ω Min.
- Dielectric Strength: AC250V for 1 Minute
- Pitch: 0.5mm
- Height: 3.4mm
- No. of Poles: 20~60 Poles
- Operating Temperature: -40 ~ +105°C
- Package: 1,500 Pcs/Reel

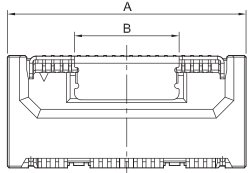

FPC • FFC Dimensions

Pad Layout

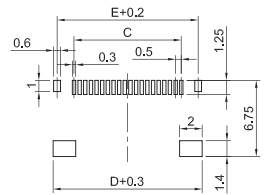
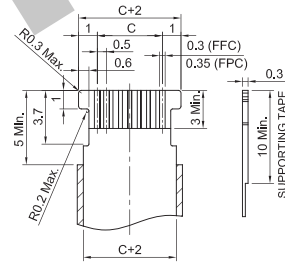
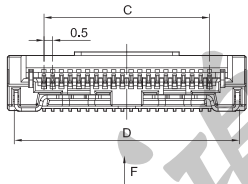

PARTS NO.	PIN	A	B	C	D	E	PARTS NO.	PIN	A	B	C	D	E
FPC26-20	20	13.7	6.0	9.5	12.9	12.3	FPC26-40	40	23.7	16.0	19.5	22.9	22.3
FPC26-25	25	16.2	8.5	12.0	15.4	14.8	FPC26-45	45	26.2	18.5	22.0	25.4	24.8
FPC26-30	30	18.7	11.0	14.5	17.9	17.3	FPC26-50	50	28.7	21.0	24.5	27.9	27.3
FPC26-32	32	19.7	12.0	15.5	18.9	18.3	FPC26-55	55	31.2	23.5	27.0	30.4	29.8
FPC26-35	35	21.2	13.5	17.0	20.4	19.8	FPC26-60	60	33.7	26.0	29.5	32.9	32.3

FPC • FFC CONNECTOR
 PITCH:0.5mm H:6.0mm
 AUTO I-LOCK™
FPC27 SERIES



- Rating: AC/DC50V 0.5A
- Insulation Resistance: 50Ω Min.
- Dielectric Strength: AC250V for 1 Minute
- Pitch: 0.5mm
- Height: 6.0mm
- No. of Poles: 20~60 Poles
- Operating Temperature: -40 ~ +105°C
- Package: 1,000 Pcs/Reel

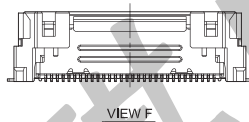
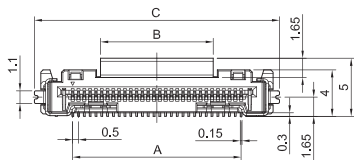

FPC • FFC Dimensions

Pad Layout

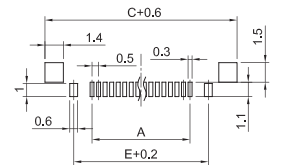
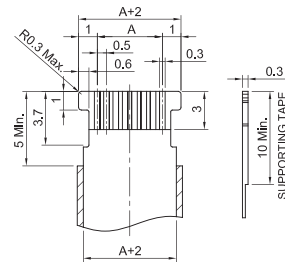
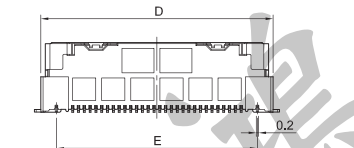

PARTS NO.	PIN	A	B	C	D	E	PARTS NO.	PIN	A	B	C	D	E
FPC27-20	20	9.5	4.7	16.1	15.0	12.3	FPC27-45	45	22.0	17.2	28.6	27.5	24.8
FPC27-25	25	12.0	7.2	18.6	17.5	14.8	FPC27-50	50	24.5	19.7	31.1	30.0	27.3
FPC27-30	30	14.5	9.7	21.1	20.0	17.3	FPC27-55	55	27.0	22.2	33.6	32.5	29.8
FPC27-35	35	17.0	12.2	23.6	22.5	19.8	FPC27-60	60	29.5	24.7	36.1	35.0	32.3
FPC27-40	40	19.5	14.7	26.1	25.0	22.3							